

EXHAUST VACUUM OPERATING & MAINTENANCE MANUAL

COMMERCIAL WET & DRY 2 MOTOR WET VACUUM WITH EXHAUST OUTLET

Read safety & operating instructions before commencing operation. These operations must be read and adhered to before operating this machine.



Phone: +61 8 93991644

Email: sales@guardasystems.com

38 hensbrook Loop, Forrestdale, Western Australia, 6112

GUARDA
WORK HARD. BREATHE EASY.

WWW.GUARDASYSTEMS.COM

Index:

GENERAL OPERATION INSTRUCTIONS

1. INTRODUCTION	2	
2. SAFETY MANAGEMENT PROCEDURES.....	2 - 3	
3. UNPACKING AND SETTING UP.....	4	
4. EMPTYING THE TANK AFTER DRY VACUUMING.....	5	
5. EMPTYING THE TANK AFTER WET VACUUMING.....	6	
6. CLEANING THE FLOAT.....	6	
7. MAINTENANCE.....	6	
8. DAILY CHECKS OR AT EACH USE.....	6	
9. 1000 HOUR OR 3 MONTHLY CHECK.....	7	
10. TROUBLE SHOOTING	7	
11. SET UP FOR USE WITH EDGE POWERCUTTER.....	9	
12. HOW IT WORKS WITH EDGE POWER CUTTER.....	10	

} GENERAL USE VACUUMING

} FOR USE WITH GUARDA
EDGE POWER CUTTER

1. INTRODUCTION

Your new Guarda Exhaust Vacuum is designed specifically with an exhaust port so that it can be used as part of a system with the Guarda Saws and other equipment which are engineered to remove fumes, slurry and dust. The Guarda Exhaust Vacuum also comes with a full range of accessories designed to make your cleaning task an easy one. To get the best from your machine we suggest you follow the operating and maintenance instructions contained in this document.

2. SAFETY MANAGEMENT PROCEDURES

These instructions must be read and adhered to before operating this machine. Failure to do so may result in injury to the operator, nearby persons, or damage to property, or to this machine.

- ☐ The packaging around the cleaner (plastic bags, clips, ties etc.) pose a choking hazard and should be kept out of the reach of children and animals.
- ☐ This machine is designed to be used by trained & competent adults. It is not to be used by children or individuals incapable of using it safely. If used incorrectly, it can be harmful.
- ☐ The end of the suction hose or blow hose and/or the accessories must be kept away from your face and the faces of others at all times during operation as the suction or blow created can cause damage to the eyes, ears and mouth.
- ☐ Do not use adapters or multiple sockets, without knowing the electrical input of each.
- ☐ If any electrical extension is used, check that it corresponds to the power requirements of the machine and that the connection of the plug with the socket is compliant and sealed.
- ☐ Take care of the electrical cable, it must be protected from water, breaks & tears and chemical agents. Do not repair the cable in case of breaks & tears, but replace it with a new one. The cable must be replaced by the manufacturer or its service agent or a similarly qualified person in order to avoid further hazard.
- ☐ **DO NOT** pull the cable to drag the machine into position or to remove the plug from the socket.

- ☐ Disconnect from the power source by pulling the plug out only when the machine is switched off.
- ☐ **DO NOT** handle the plug with wet hands.
- ☐ Unplug the cable before servicing the machine.
- ☐ Never use flammable liquids or operate machine in or near flammable liquids, vapors or combustible dusts.
- ☐ Should the machine leak liquid or foam, make unusual noises or get abnormally hot, switch off the machine immediately and take it in for a service.
- ☐ Do not vacuum materials that could damage filters such as glass or metal shavings
- ☐ This machine should **NEVER** be immersed in water.
- ☐ DO NOT use solvent or strong detergents to clean this machine.
- ☐ Store the machine in a well cleaned state and in a cool & dry place.



WARNINGS:

All electrical repairs must be performed by qualified personnel only!
Guarda Systems cannot be held responsible for any damage/injury caused to persons or property, due to the incorrect use of the machine caused by procedures being performed which are not specified in this instruction manual.

3. UNPACKING AND SETTING UP

Read safety and operating instructions before commencing operation. Assembly details and information on how to carry out various cleaning operations are outlined below:

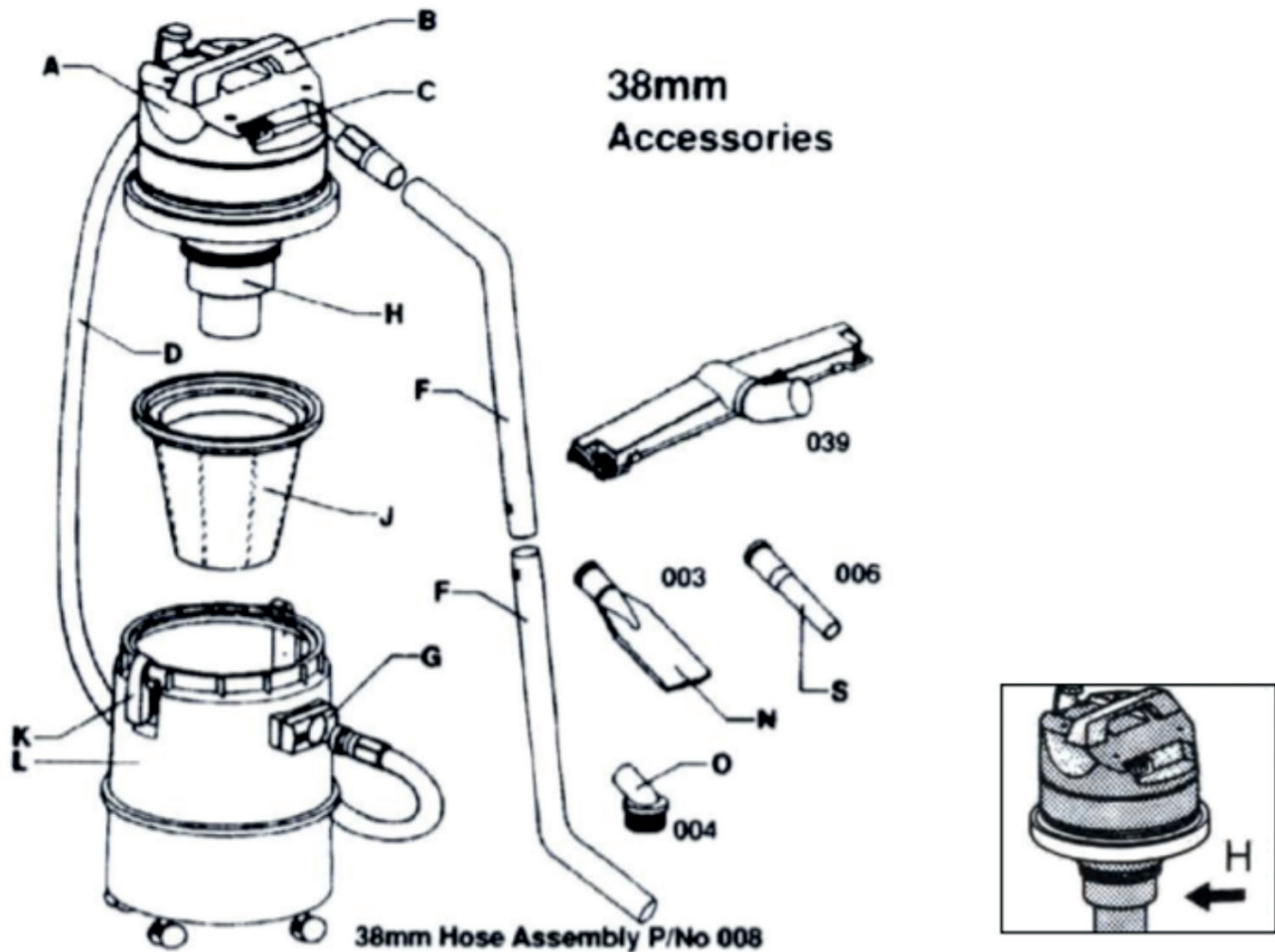

Schematic – General Tank & Tool Configuration

- ☐ Lift the machine out of the box by gently angling the box and pulling the vacuum cleaner by its carry handle.
- ☐ Insert the flexible hose (D) into the tank inlet (G) and press until you hear a click as it locks into place. Unclip the two clips (K) on the side of the motor head (A) and lift the motor from the tank (L).

USING AS A CONVENTIONAL VACUUM CLEANER

- ☐ If Dry Vacuuming: Ensure that the cloth filter (J) and its bag support ring are fitted into the top of the tank (L), replace the motor head (A) back onto the tank and clip into place. Note: Failure to use the fabric filter during dry operation will result in motor failure due to clogging and overheating the motor thereby nullifying the motor warranty.

- ☐ If Wet Vacuuming: Ensure that the cloth filter and its support ring (J) have been removed and replace the motor head (A) back onto the tank and clip into place.
- ☐ Screw the top extension wand (F) into the suction hose (D)
- ☐ Fit the two piece extension wands (F&F) together.
- ☐ Select one of the following tools: Dry Floor Tool, Wet Floor Tool, Round Brush, Confined Space Tool or Crevice Tool and fit it to the lower end of wand (F).
- ☐ Your Guarda Exhaust Vacuum is designed to operate on 220- 240volt 50Hz single phase power. Check that the voltage of the machine matches the voltage output of your power point then plug the machine in. Your machine is now ready to use. The suction power can be adjusted by turning 1 or 2 motors on together or independently. It is important that machine tanks be emptied regularly, preferably after each use.
- ☐ Your Guarda Exhaust Vacuum comes with tools to use for vacuuming hard floors in both wet and dry applications.

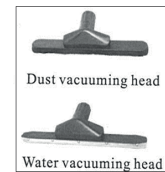

WARNINGS:

Failure to use the fabric filter during dry operation will result in motor failure due to clogging and overheating of the motor thereby nullifying the motor warranty.

4. EMPTYING THE TANK AFTER DRY VACUUMING.

Turn off and unplug your vacuum cleaner from the mains power. A build-up of dust and debris in the filter bag will result in the filter becoming clogged, which in turn places excessive load on the motor and may lead to it burning out. It's therefore extremely important to empty and clean the filter bag after every use to ensure maximum operating efficiency. From time to time you should also wash your filter bag with water. Allow it to dry before re-use.

- ☐ Debris can be emptied by removing the motor head (A) and the cloth filter (J), gently shake the cloth filter before removing it from the tank (L). If not using the system with an additional collection bag, then move tank (L) to a disposal area and tip the contents of the tank into the rubbish. Also shake the dust from the filter bag into the rubbish.
- ☐ The cloth filter (J) can be removed from the filter ring and washed by hand or in a washing machine. Ensure the filter is thoroughly dry before refitting to the machine. Cloth filter bags should be replaced at least every 12 months.
- ☐ It is recommended that disposable filter bags be used when vacuuming fine dust. The use of such bags improves the performance of the vacuum cleaner, protects the motor and protects operators from excess dust inhalation when emptying the tank.
- ☐ To fit a disposable filter bag simply push the cardboard bag support firmly over the internal tank inlet so that it sits snugly in place.

- ☐ To ensure you use the right disposable filter bag for your vacuum model talk to the team at Guarda, who will provide you with all the part numbers and information you need.

5. EMPTYING THE TANK AFTER WET VACUUMING.

- ☐ Turn off and unplug your vacuum cleaner from the mains power and wheel the vacuum cleaner to an appropriate disposal area. Detach head clamps (K), remove head (A) and gently tip fluid from tank. Emptying tank can be done quickly by opening the tank drain hose.
- ☐ Dry the tank thoroughly prior to re-assembly of the machine.



6. CLEANING THE FLOAT

The underside of the motor head is fitted with a float (H) which, when wet vacuuming, prevents the container overfilling. The float also prevents the liquid from penetrating into the motor of the machine should the vacuum cleaner tip over. In order to keep the machine in good operational condition, the float (H) must be cleaned at regular intervals. After wet vacuuming the tank, motor heads and accessories should be cleaned and wiped dry.

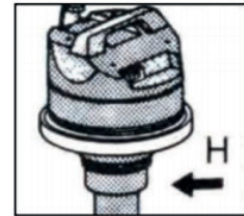

7. MAINTENANCE

If foam or liquid comes from the machine exhaust, switch off machine immediately by isolating at the mains.

- ☐ Check float level device for cleanliness and correct operation.
- ☐ Empty machine after isolating at mains socket
- ☐ Dry the machine body with a cloth before re-using.
- ☐ Allow the machine to dry out thoroughly before re-use
- ☐ Should the machine still leak, make strange noises or become abnormally hot, stop all use and take it into an approved service agent for repair. Maintenance of electrical components should only be carried out by a certified electrician otherwise return the machine to your nearest Guarda Branch or Service Agent for repair. **Never carry out any repairs without first disconnecting machines from the mains supply.**

8. DAILY CHECKS OR AT EACH USE

- ☐ Check for correct operation of high-water level cut-off float device. Ensure float is free to operate and that the seat on the underside of the motor housing is in good condition. Ensure the float gauze cage is clean and wash out the tank with clean water after use. This prevents the buildup of bacteria and unpleasant odours, which can become a problem if your machine is left uncleaned for long periods of time.

- ☐ Check the machine switch(s) for damage, ensure plastic switch cover is soundly in place, check that the cloth filter bag (J) is not clogged, replace cloth filter bag every 12 months or when necessary in high use applications.
- ☐ Check mains cable and plug for damage.
- ☐ Check hoses, extension tubes, accessories for damage or blockage (unseen blockages sometimes occur so check thoroughly).
- ☐ Examine cloth filter bag (replace or clean).
- ☐ Check the machine for damage

9. 1000 HOUR OR 3 MONTHLY CHECK

- ☐ Examine vacuum motors for carbon brush wear. Remove all traces of carbon with a fine dry brush. Ensure no traces of moisture are present.
- ☐ Carry out full electrical safety check.

10. TROUBLESHOOTING

Trouble	Possible Cause	Remedy
Insufficient vacuum	Filter clogged and blocking airflow (dry vacuuming only)	Clean filter and empty tank.
	Tank full with float blocking motor inlet (wet vacuuming only)	Empty tank
	Faulty motor	Return to Guarda Service Agent and have motor replaced.
	Hose or tooling are cracked and disrupting suction	Repair and replace as required
	Hose is blocked	Unblock the hose
Vacuum overheats	Filter clogged and blocking airflow (dry vacuuming only)	Clean filter and empty tank.
	Faulty motor	Return to Guarda Service agent and have motor replaced.
Float closes off	Waste water tank is full	Empty waste water tank

Guarda workshop & service agent facilities are staffed by experienced technicians providing servicing, repair and manufacturing for a range of products including; vacuum cleaners, extractors, fume, slurry and dust extraction equipment, pumps and more.

For more information on this product, to book in a service or repair or to order spare parts give Guarda or a Guarda distributor a call or email your enquiry via our website.

Email: sales@guardasystems.com

Phone: +61 (8) 93991644

11. SET UP FOR USE WITH EDGE POWERCUTTER

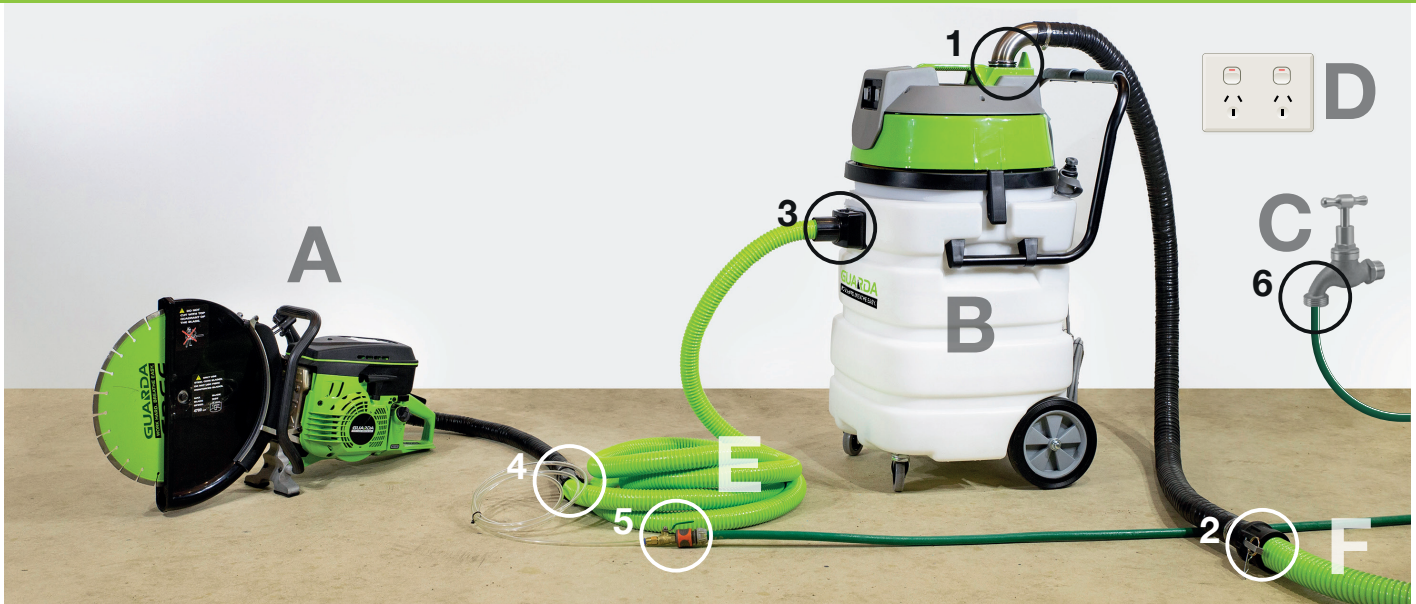

What is required?

- A) Guarda Edge Power Cutter C) Pressured Water Supply E) 38mm/1.5" Guarda Slurry Hose*
 B) Guarda Electric Exhaust Vacuum D) Power Outlet 220V/10A F) 50mm/2" Guarda Exhaust Hose**
 (Comes with Kevlar connecting hose) *(Max. length 5m/15ft) **(Max. length 60m/200ft)

Set up procedure

1) Connect Kevlar connecting hose to the Guarda Electric Exhaust Vacuum exhaust port. It has a bayonet type fitting that locks in a clockwise rotation.



2) Connect the 50mm/2" exhaust hose to the Kevlar connecting hose to exhaust the Edge engine fumes outside in a well ventilated place. You can extend the 50mm/2" Guarda Exhaust hose to a maximum of 60m/200feet.



3) Connect 38mm/1.5" slurry hose to the Guarda Electric Exhaust Vacuum inlet. (hose length not to exceed 5m/15 ft between Guarda Electric Exhaust Vacuum & Edge Powercutter.



4) Connect 38mm/1.5" slurry hose to Edge Powercutter.



5) Connect water hose to Edge Powercutter

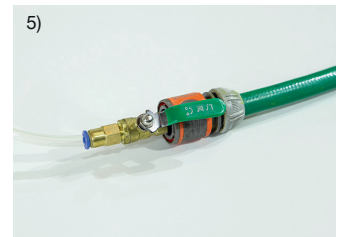

6) Connect water hose to pressured water supply



7) Connect Guarda Electric Exhaust Vacuum power lead to power point.

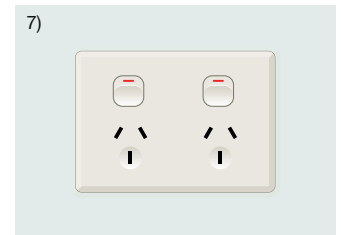

The end of the exhaust hose must be placed outside in a well ventilated area

12. HOW IT WORKS WITH EDGE POWER CUTTER

IDEAL FOR INDOOR CUTTING APPLICATIONS

Removes silica dust, slurry and exhaust fumes for safe, convenient concrete cutting indoors and out



www.guardasystems.com



BENEFITS COMPARISON - GUARDA VS CONVENTIONAL SAWS

	Wet Cutting	Dry Vacuum (LEV)	Guarda (water & vacuum combined)
Silica Dust (Hazardous when breathed in)	Dust contained in water mist	Residual dust released into the breathing zone. Dust present during clean up	✓ Virtually no silica dust detected in breathing zone
Slurry (must be cleaned up after cutting)	100% released onto ground and walls	N/A as no water used	✓ Virtually none (approx 99% captured)
CO fumes (Create a hazard when cutting indoors or in enclosed spaces)	Emitted from exhaust when using petrol saws	None with electric saws. Emitted from exhaust when using petrol saws	✓ Removed safely to outside area
Set up/Clean Up	Slurry clean up required	Dust clean up required	✓ Virtually no clean up required
Cost	Purchase costs can be high. Clean up and disposal costs	Purchase costs can be high especially if 3-phase power required	✓ Value for money to purchase with low operating costs

HOW IT WORKS

